

# SPCL-00726 - High Power JTIDS/MIDS Triple Band Bandpass Filter

## ◆ Features:

- Designed for co-location of Link 16, TTNT, and IFF
- Low Passband Loss
- High Power Handling
- Rugged Compact Design for Harsh Environments
- Mechanical Dimensions: 6.76" x 2.41" x 2.32"



## ◆ Specifications:

### Minimum Passbands:

962-1008 MHz  
 1053-1065 MHz  
 1113-1215 MHz

**Passband Insertion Loss:** .75 dB Max

**Maximum Passband VSWR:** 1.7:1

**Average Group Delay:** 22 ns

**Stopbands:** 1023-1037 MHz  
 1083-1097 MHz

### Minimum Stopband Rejection:

-30 dBc DC - 700 MHz  
 -45 dBc 1023-1037 MHz  
 -45 dBc 1083-1097 MHz  
 -60 dBc 1500-3000 MHz  
 -45 dBc 3000-6000 MHz

**Maximum Power:** 500 Watts Average

**Size:** 6.76 x 2.32 x 2.41 inches  
 (171.70 x 58.93 x 61.21 mm)

### Connectors:

**Input:** N Female

**Output:** N Female

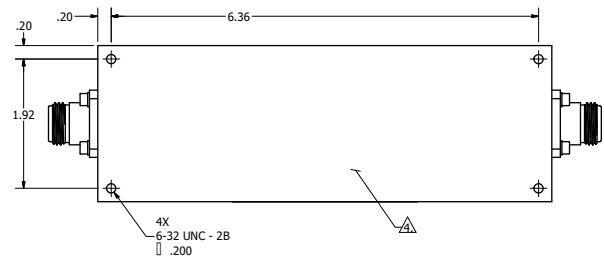
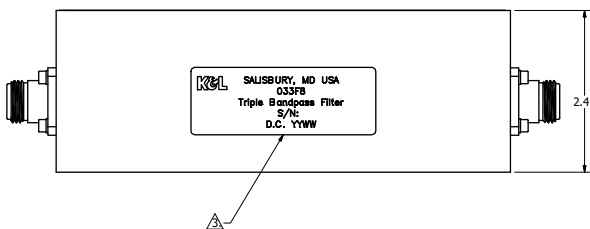
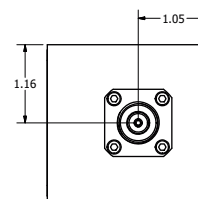
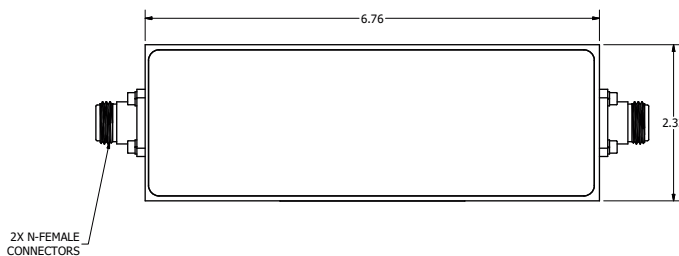

# SPCL-00726 - High Power JTIDS/MIDS Triple Band Bandpass Filter

## ◆ Performance Data:

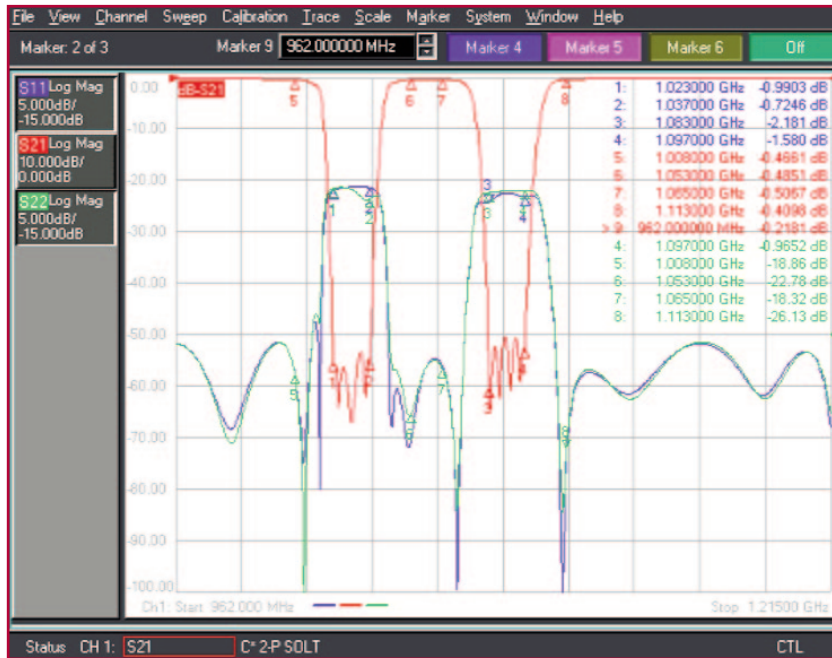

Performance Close In-Band

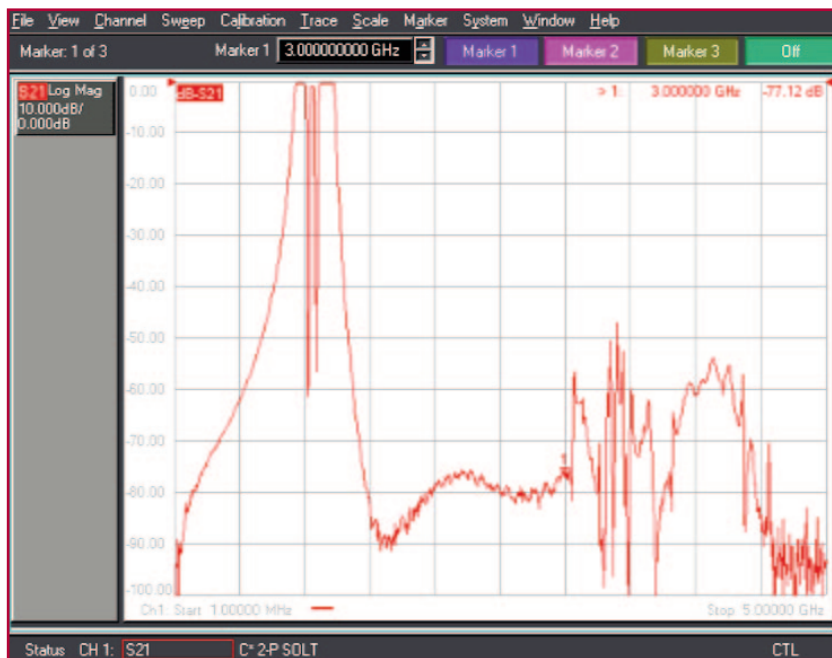

Broad Passband Performance